

HOTELS
1. VISALIA HOLIDAY INN - 559-651-5000
2. JOHN JAY INN - 559-651-3700
3. LA QUINTA INN & SUITES - 559-739-9800
4. FAIRFIELD INN (MARRIOTT) - 559-636-7600
5. VISALIA MARRIOTT - 559-636-1111

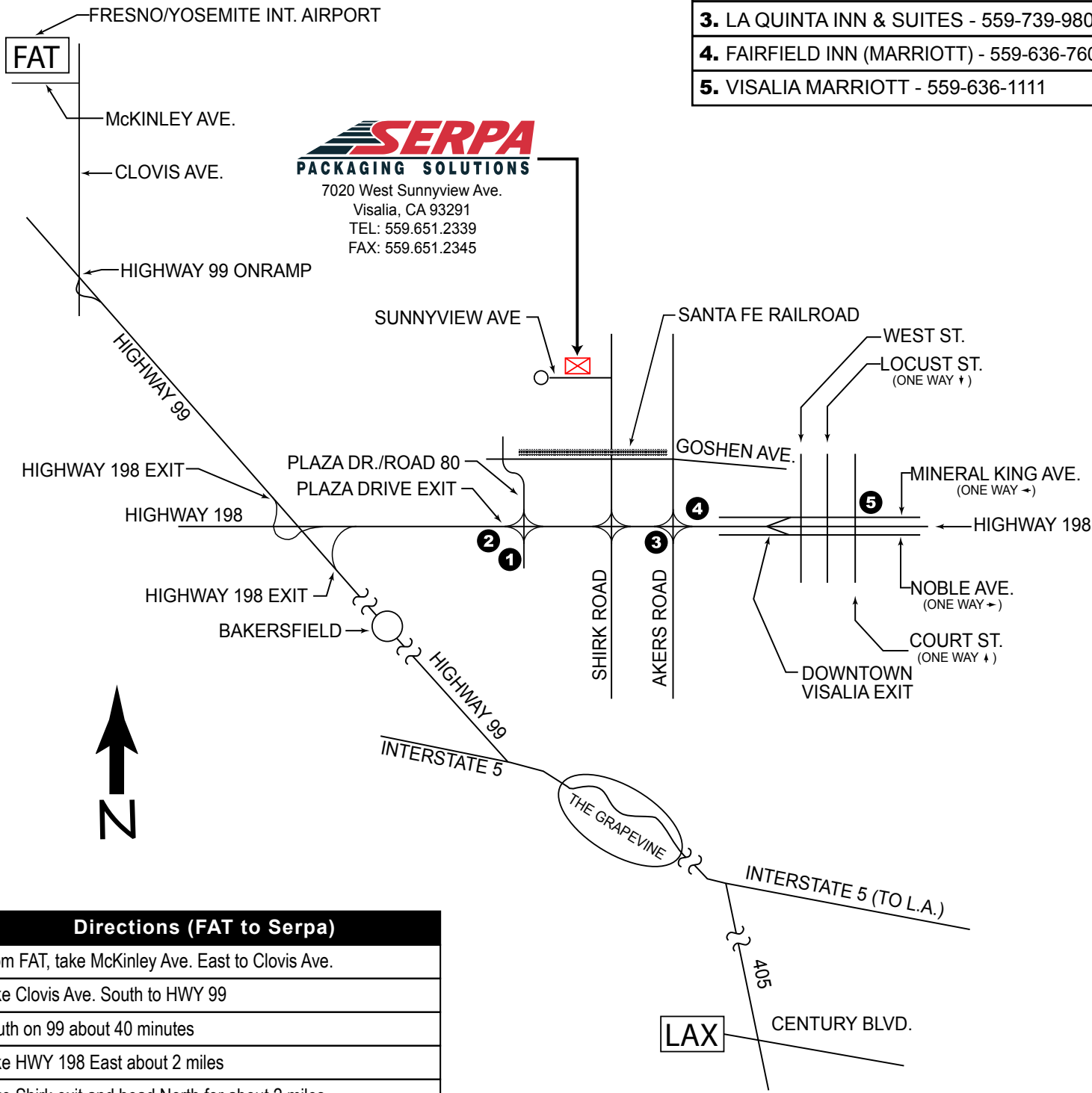

SERPA
PACKAGING SOLUTIONS
 7020 West Sunnyview Ave.
 Visalia, CA 93291
 TEL: 559.651.2339
 FAX: 559.651.2345



Directions (FAT to Serpa)
From FAT, take McKinley Ave. East to Clovis Ave.
Take Clovis Ave. South to HWY 99
South on 99 about 40 minutes
Take HWY 198 East about 2 miles
Take Shirk exit and head North for about 2 miles
Turn left on Sunnyview Ave. to Serpa building on right

Directions (LAX to Serpa)
From LAX, take San Diego FWY (405) North
Proceed to Golden State HWY (5) North
Past The Grapevine, take HWY 99 North
About 1 hr. past Bakersfield, take HWY 198 East about 2 miles
Take Shirk exit and head North for about 2 miles
Turn left on Sunnyview Ave. to Serpa building on right

Approximate Travel Times
FAT to Visalia - 1 hour
LAX to Visalia - 3 1/4 hours
SFO to Visalia - 3 1/2 hours
Visalia Holiday Inn to Serpa - 5 minutes
Visalia Marriott to Serpa - 8 minutes